



# Crossbar Bracket EDG-2K-20C

## Assembly Instructions Sheet

For more information please visit:  
[www.everwellparts.com](http://www.everwellparts.com) [info@everwellparts.com](mailto:info@everwellparts.com)

### Bill of Fittings

- 1) Fixing bolt for fastening the outdoor unit.  
Size: M8\*30mm.  
Optional.



- 2) Screw for fastening the hanging plate and side plate.  
Size: M8\*60 (1K)  
Size: M8\*65 (2K)

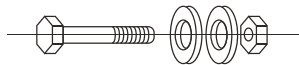

- 3) Anti-vibration mounts 4pcs.  
Size: 1.57\*1.57\*0.31in  
40\*40\*8mm  
M8 plastic nut: 4pcs.  
Optional.

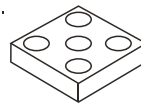

- 4) Screw for fastening to the wall.  
(SSB460CB/B460CV 5pcs)  
(SSB560CB/B560CV 5pcs)  
Size: M8\*80mm

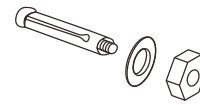

- 5) Arm lock 2pcs.  
Screw for fastening the fixing metal 2pcs.  
Size: M8\*30

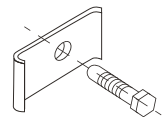

### Assembly

- 1) Fasten crossbar to the wall  
2) Slide arms into the crossbar  
3) Slide arm locks into the crossbar  
4) Insert fastener into each arm lock. Do not tighten yet

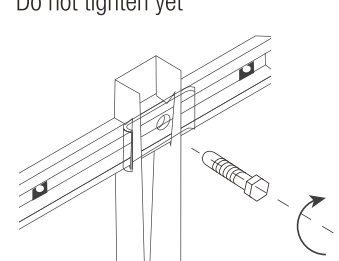
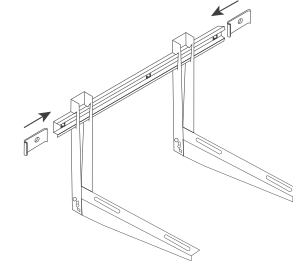
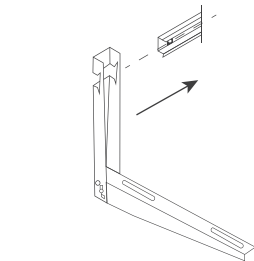
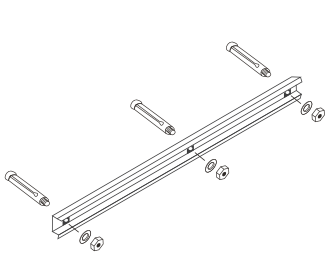

- 5) Adjust arms to suit air conditioner

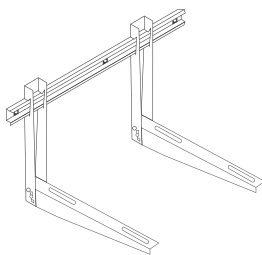

- 6) Alternative installation method

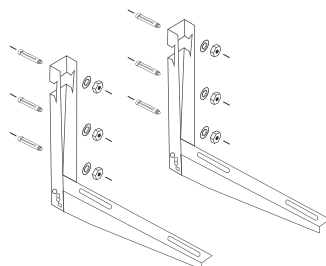

- 7) Unfold the arms down, tighten hinge bolts and affix mounting assembly

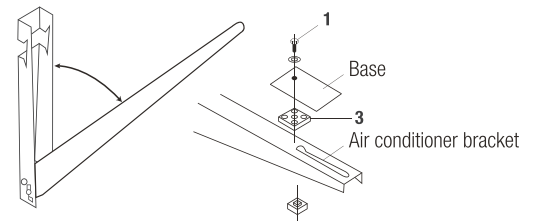

### Sizes

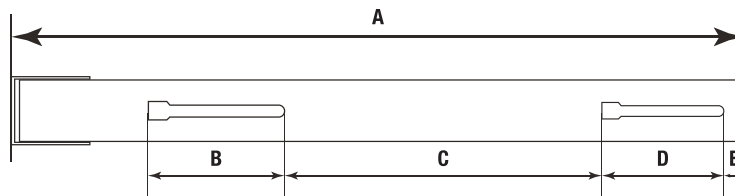

| Capacity A/C   | Unit  | A           | B          | C          | D         | E         |
|----------------|-------|-------------|------------|------------|-----------|-----------|
| 9000-18000BTU  | in/mm | 17.76 / 450 | 4.13 / 105 | 6.5 / 165  | 2.91 / 74 | 0.59 / 15 |
| 18000-24000BTU | in/mm | 21.65 / 550 | 4.13 / 105 | 9.25 / 235 | 3.74 / 95 | 0.59 / 15 |

Note: Ensure that the wall bracket is mounted properly to handle applied loads as wall construction may vary. The wall bracket must be securely fixed to wall with all screws fastened tightly. Do not make any modification to bracket assembly or fixings. What is mentioned is subject to change without notice. Please check that all screws and bolts are secured tightly before placing the unit on it.